

Proportional Actuator Guide

Description

Our Proportional Controller Modules can be operated using a **Rocker Actuator** or a **Flex Button Actuator**. The proportional modules can also be installed in the **Trigger** location on the "C", "J" and "L" Series control handles.

Our **Rocker Actuator** uses a faceplate assembly. This design uses the same unique "Sure Grip Flexing Membrane" technology that has proven so successful in the mobile equipment industry. By using this technology, we have virtually eliminated the problems associated with contamination from dirt, water and ice that is common to most rocker switches. The Rocker Lever is securely mounted atop our flexing membrane that acts as a seal and a pivot. (See fig. 1)

The Rocker Faceplate can be used to operate our standard on/off switches and/or proportional modules. (consult factory)

The **Rocker Actuators** are suitable for use by both gloved or bare hand operators.

The Rockers are available for the "C" and "L" Series handles in both single (2 functions) and dual rocker (4 functions) configuration.

The **Flex Button Actuator** is an individual "push button style" actuator used to operate a single proportional module. It is used with our standard faceplate and can be installed in most of the existing faceplate switch locations. The Flex Buttons has the same durability and exceptional environmental protection that is associated with all Sure Grip handles.

The Flex Button Actuators use a tough molded Silicone membrane that provides the travel and environmental sealing needed for the actuator. A hard "button" is mounted in the center of the Silicone membrane that protects the flexing material and provides excellent tactile feel to the operator. (See fig. 2)

The Flex Button Actuators can be used in most of the faceplate positions on the "C", "J" and "L" series control grips. (consult factory)

Features:

- + Three actuator styles: operate switches or Proportional Modules
- + Actuator rating: more than 5 million cycles Flex Buttons fit "C" and "L" series control grips
- + Trigger and Rocker Actuator for "C","J" and "L" series control grips
- + Actuation force typical: 350 - 500 grams
- + Operating temperature range: -358 C to +508 C
- + Gloved or bare hand operation
- + Not affected by dirt, water or ice
- + Custom graphics available on faceplate or rocker lever

Typical Configurations

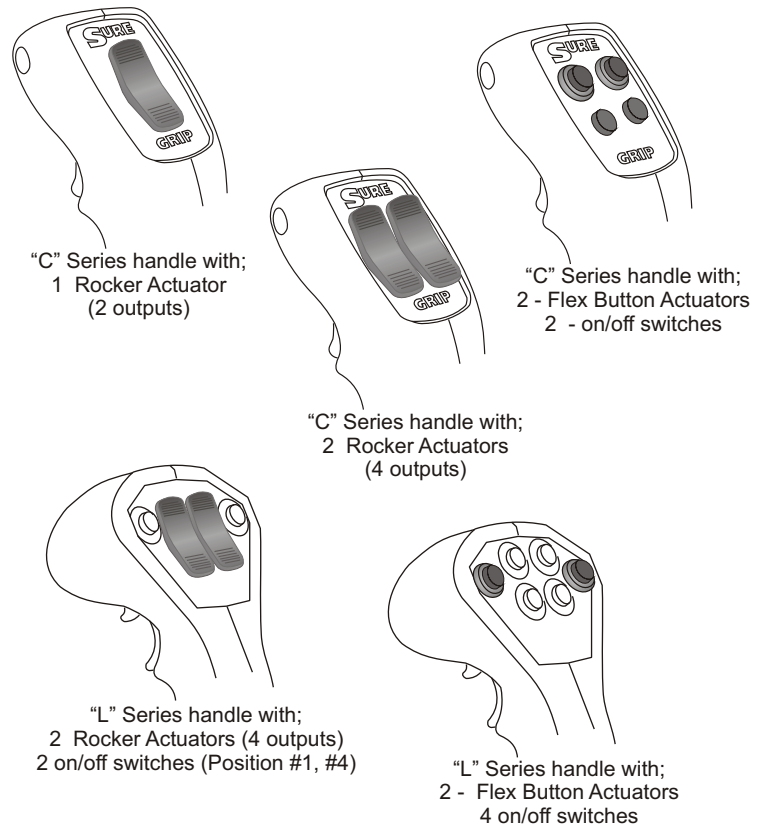

Fig. 1: Rocker Actuator Cross Section

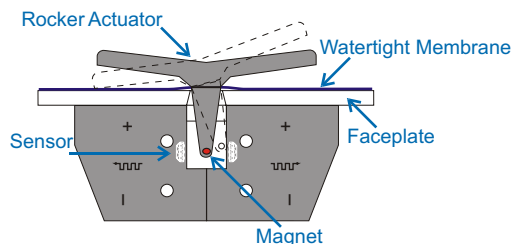

Fig. 2: Flex Button Actuator Cross Section

